

ATRIO
Dual Function Pressure Balance
Trim with Control Module

MODEL # 19867003

*Pure Freude
an Wasser*

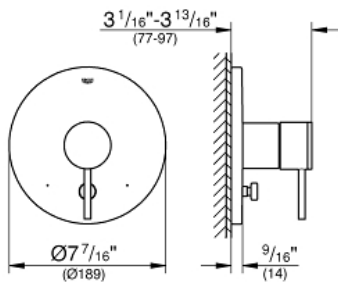

Product Description:

ATRIO

Dual Function Pressure Balance Trim with Control Module

Standard Specification:

- For shower/tubs with non-diverter tub spout or for 2 shower outlet applications
- Integrated volume control
- 2-way diverter function
- 1 axis operation
- For use with Grohsafe Rough-In Valve with Built in Diverter 35 016 or 35 033
- 5.3 gpm (20 l/min) at 45 psi (bottom outlet)
- 2.9 gpm (11 l/min) at 45 psi (top outlet)
- ABS trim plate
- **GROHE StarLight** chrome finish

Color:

- 19867003 StarLight Chrome

EUPHORIA 110 DUO
Shower Rail Set 2 Sprays
MODEL # 27242001

Pure Freude
an Wasser

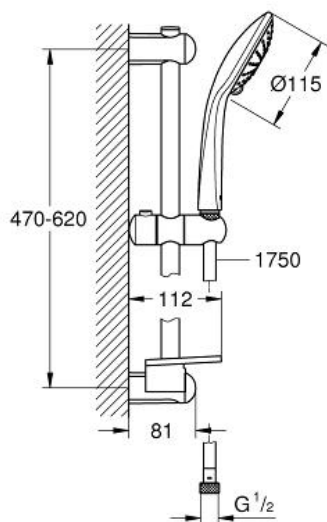

Product Description:
EUPHORIA 110 DUO
Shower Rail Set 2 Sprays

Standard Specification:

- Consisting of:
- Euphoria hand shower (27 238 000)
- 24" shower bar (27 499 000)
- 69" Silverflex shower hose (28 388 000)
- **GROHE EasyReach** tray (27 596)
- 2.5 gpm (9.5 l/min) flow limiter
- **GROHE DreamSpray** perfect spray pattern
- **GROHE SprayDimmer** (flow rate reduction)
- **GROHE StarLight** chrome finish
- GROHE QuickFix (upper bracket adjustable for adaption to existing drilling holes)
- **SpeedClean** anti-lime system
- Inner WaterGuide for a longer life
- Twistfree to prevent hose from twisting
- Suitable for instantaneous heater
- Min. recommended pressure: 15 psi (1.0 bar)

Applicable Codes & Standards:

- Energy Policy Act of 1992
- ASME A112.18.1/CSA B125.1

Color:

- 27242001 StarLight Chrome

26 457

EUPHORIA®

260 SHOWER HEAD, 10" - 3 SPRAYS

*Pure Freude
an Wasser*





STANDARD SPECIFICATION:

- GROHE StarLight®
- GROHE DreamSpray®
- Speed Clean® anti-lime system
- 10" Face
- 3 Sprays: Jet, SmartRain, Rain
- Rotate 360° center dial to change sprays
- 1/2" NPT Female threads
- Inner WaterGuide for a longer life
- Max. flow rate: 2.5gpm (9.5L/min)





PRODUCT FEATURES:

-  GROHE StarLight®
-  GROHE DreamSpray®
-  Speed Clean®

CERTIFICATIONS:

- Massachusetts Plumbing Board Approved
- Energy Policy Act of 1992
- CSA B125.1
- ASME A112.18.1

AVAILABLE FINISHES:

- 26457000**  GROHE StarLight® Chrome
- 26457EN0**  Brushed Nickel InfinityFinish™

NOTE: Install this product according to the installation guide. ADA, CSA compliant when installed to the specific requirements of these regulations.

Tel: 1.630.582.7711 Fax: 1.630.582.7722

We reserve the right to make revisions without notice to product specifications.

For the most current Specification Sheet, go to www.grohe.us.

10-20-2021

PART OF **LIXIL**

26 457

EUPHORIA®

260 SHOWER HEAD, 10" - 3 SPRAYS

*Pure Freude
an Wasser*



TECHNICAL DATA:

Product Height	3-3/8 in
Product Length	10-1/4 in
Product Width	10-1/4 in
GPM (Min)-GPM (Max)	2.5 gal (US)/min

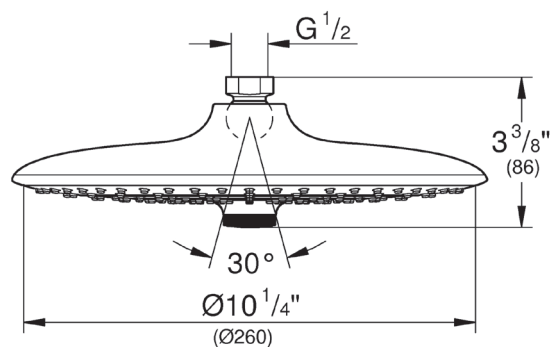

28 577

RAINSHOWER™

11 1/4" SHOWER ARM

*Pure Freude
an Wasser*



STANDARD SPECIFICATION:

- GROHE StarLight®
- 11 1/4" Shower Arm
- 1/2" NPT male threads
- Can be used with any shower head EXCEPT Rainshower™ Jumbo (28 783)



PRODUCT FEATURES:



GROHE StarLight®

CERTIFICATIONS:

- CSA B125.1
- ASME A112.18.1

AVAILABLE FINISHES:

28577000



GROHE StarLight®
Chrome

28577EN0



Brushed Nickel
InfinityFinish™

NOTE: Install this product according to the installation guide. ADA, CSA compliant when installed to the specific requirements of these regulations.

Tel: 1.630.582.7711 Fax: 1.630.582.7722

We reserve the right to make revisions without notice to product specifications.

For the most current Specification Sheet, go to www.grohe.us.

10-27-2021

PART OF LIXIL

28 577

RAINSHOWER™

11 1/4" SHOWER ARM

*Pure Freude
an Wasser*



TECHNICAL DATA:

Product Height	3-3/8 in
Product Length	11-1/4 in
Product Width	2-9/16 in

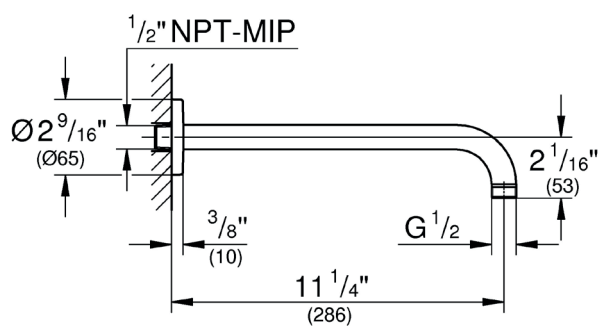

RAINSHOWER
Shower Wall Union, 1/2"
MODEL # 26635A00

Pure Freude
an Wasser

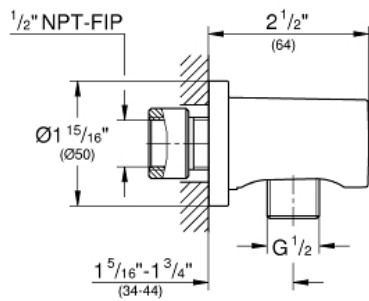

Product Description:
RAINSHOWER
Shower Wall Union, 1/2"

Standard Specification:

- 1/2" NPT Female Threads
- Check valve included to prevent backflow
- GROHE StarLight finish

Applicable Codes & Standards:

- ASME A112.18.1/CSA B125.1
- LOGO CEC

Color:
□ 26635A00 Hard graphite

GROHSAFE
Pressure Balance Rough-In Valve
with Built-In Mechanical Diverter
MODEL # 35016000

Pure Freude
an Wasser

GROHE

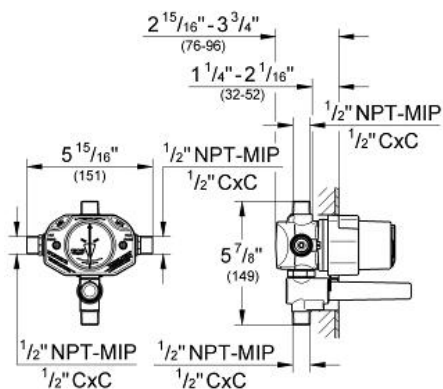

Product Description:

GROHSAFE

Pressure Balance Rough-In Valve with Built-In Mechanical Diverter

Standard Specification:

- With built-in diverter
- Handle limit stop
- Diaphragm cartridge
- Check valves
- Built-in diverter
- Service stops
- Universal connection is 1/2" male by copper sweat
- Max Flow Rate 5.8 gpm at 45 psi (22 L/min)

Applicable Codes & Standards:

- Energy Policy Act of 1992
- ASME A112.18.1/CSA B125.1

Color:

□ 35016000