

ME by Starck Toilet wall-mounted Compact Duravit Rimless® #
 253009..92 / 253009..92 / 253009..92 / 253009..92

| < 14 5/8" Inch > |

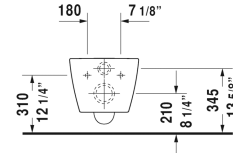
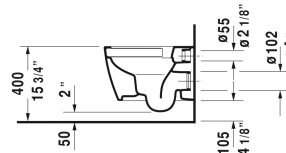
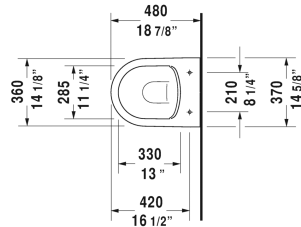

Toilet wall-mounted Compact Duravit Rimless®	Dimension	Weight	Order number
rimless, washdown model, Durafix included, cUPC® listed*, WaterSense® listed			

Colors

00 White 20 HygieneGlaze (an antibacterial ceramic glaze that provides almost indefinite effectiveness) 26 White/White Satin Matte 90 White HygieneGlaze/White Satin Matte

Variant

● inside color White, outside color White, 1.28/0.8 gpf	14 5/8" x 18 7/8" Inch	52 lb	253009..92
● inside color White, outside color White Satin Matte, 1.28/0.8 gpf	14 5/8" x 18 7/8" Inch	52 lb	253009..92
● inside color White, outside color White, 1.28/0.8 gpf	14 5/8" x 18 7/8" Inch	52 lb	253009..92
● inside color White, outside color White Satin Matte, 1.28/0.8 gpf	14 5/8" x 18 7/8" Inch	52 lb	253009..92

Infobox

* Complies with following standards: ASME A112.19.2/CSA B45.1 and ASME A112.19.14, Durafix for concealed installation is included, In-wall tank & carrier and actuator plate required for installation

Sanitary ceramics with the special WonderGliss surface finish will remain clean and attractive-looking for a long time to come.
 When ordering WonderGliss please add a "1" as eleventh digit to the model number.

Accessory for ceramics

Toilet seat and cover removable, hinges stainless steel, with slow close		4.4 lb	002019
Toilet seat and cover hinges stainless steel, without slow close		4.4 lb	002011
Noise reduction gasket			Schallschutz-Set 005090
Actuator plate A1, for toilet, plastic mechanical actuation, for surface mounted installation, dual flush, mounting frame, mounting hardware included, push rods, front plate plastic	8 1/2" x 5 3/4" Inch	0.7 lb	WD5008

ME by Starck Toilet wall-mounted Compact Duravit Rimless® #
 253009..92 / 253009..92 / 253009..92 / 253009..92

|< 14 5/8" Inch >|

<p>Toilet in-wall tank & carrier, Standard WaterSense® listed, For 2"x4" and 2"x6" wall installation, for toilets with a projection of <= 24 5/8", adjustable feet 0" - 9 1/2", SensoWash ready, mechanical front flush actuation, includes in-wall tank, marking of filling height, dual flush, insulated against condensation, Scope of delivery, HDPE wall-mounted toilet connection bend DN 90/90, PE wall-mounted toilet connection set DN 90, wall-mounted mounting rods M12, mounting hardware included, 2 bolt caps, cUPC® listed*, Load capacity = 880 lbs</p>	<p>23 1/4" x 45 1/4" Inch 35.3 lb</p>	<p>WD1022</p>
--	---------------------------------------	---------------

All drawings contain the necessary measurements which are subject to standard tolerances. They are stated in inch & mm and are non-binding. Exact measurements, in particular for customized installation scenarios, can only be taken from the finished ceramic piece.