

SensoWash® u SensoWash® u integrated shower-toilet # 622000011001300

| < 15 1/2" Inch > |

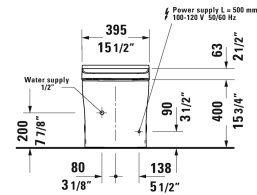
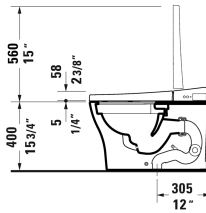
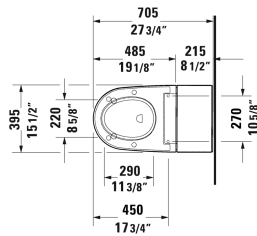

SensoWash® u integrated shower-toilet	Dimension	Weight	Order number
<p>Rear-, Lady- and Comfortwash, vertical outlet, heated seat, Intelligent energy-saving mode, warm air dryer, individual adjustment of water-, air- and seat surface temperature as well as nozzle position and jet strength, with integrated flushing system, Auto flush, pre-flush, automatic opening/closing of lid, Electronically actuated lid, seat/lid material thermoplastic, descaling function, night light, 2 individually programmable user profiles, remote control included, app operation, self-cleaning wand, on / off-button, 18 7/8" Inch</p>			
Colors			
01 White			
Variant			
AC 100-120V, 50-60 Hz, 1.32/0.92 gpf	15 1/2" x 27 3/4" Inch	110.2 lb	622000011001300
Infobox			
<p>* Complies with following standards: ASME A112.19.2/CSA B45.1 and ASME A112.19.14, Complies with following standards: ASME A112.4.2/CSA B45.16, UL 1431, CSA C22.2 No. 68-14 and CSA C22.2 No. 64-14</p>			

All drawings contain the necessary measurements which are subject to standard tolerances. They are stated in inch & mm and are non-binding. Exact measurements, in particular for customized installation scenarios, can only be taken from the finished ceramic piece.