

# BRIZO®

## SINGLE HOLE FREESTANDING FLOOR MOUNTED TUB FILLER ROUGH-IN

- R70100
- R70100-WS (With Stops)

### STANDARD SPECIFICATIONS

- 1/2" NPT female inlets.
- Forged brass body.
- Available with integrated stops (R70100-WS).
- Innovative mounting system provides for simple stable installation.
- Accommodates finished floor thickness up to 3".
- Vertical spout height remains constant to finished floor.
- Pre-assembled test caps allow air or water pressure testing without trim.
- Pre-assembled protective plasterguard with information label indicating finished floor location.
- Pre-assembled gasket to isolate living space.
- Rigid galvanized installation template included (not shown).
- Refer to product installation instructions.
- Trim sold separately.

### WARRANTY

- Parts and Finish – Lifetime limited warranty; or for commercial purchasers, 10 years for multi-family residential (apartments and condominiums) and 5 years for all other commercial uses, in each case from the date the product is received by the original purchaser or their authorized representative (installation contractor, etc.).
- Please go to [www.brizo.com](http://www.brizo.com) for the complete details of our limited warranty.

### COMPLIES WITH:

- ASME A112.18.1 / CSA B125.1

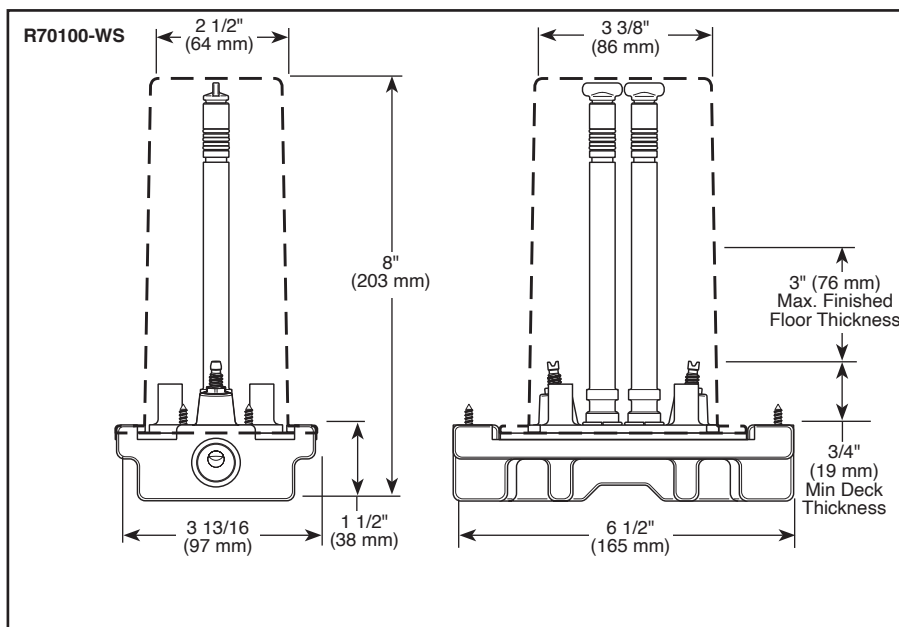
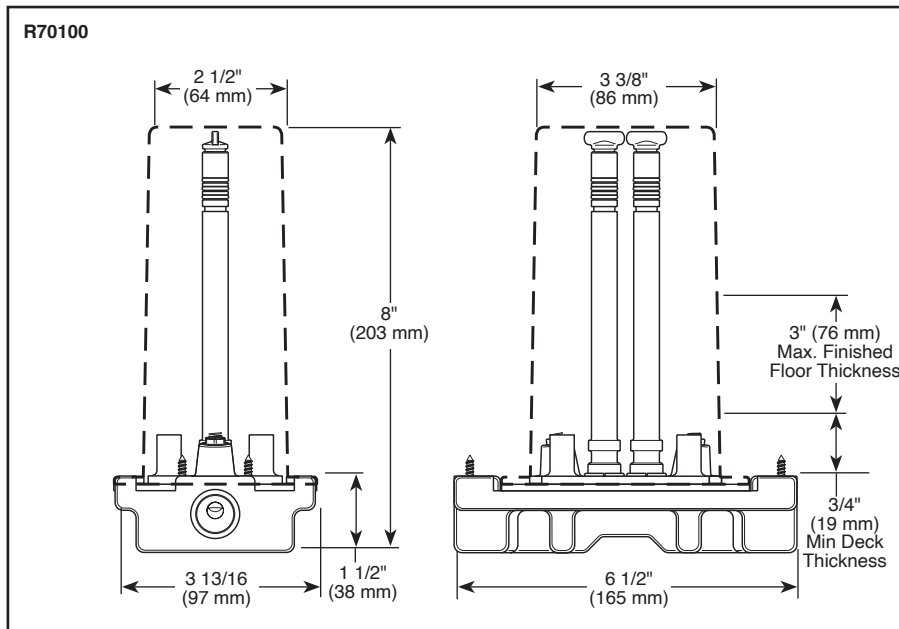

Brizo Kitchen & Bath Company reserves the right (1) to make changes in specifications and materials, and (2) to change or discontinue models, both without notice or obligation. Dimensions are for reference only. See current full-line price book or [www.brizo.com](http://www.brizo.com) for finish options and product availability.

BSP-B-R70100 Rev. D

**Brizo Kitchen & Bath Faucet Company**  
55 E. 111th Street, Carmel, IN 46280  
350 South Edgeware Road, St. Thomas, ON N5P 4L1  
© 2025 Brizo Kitchen & Bath Faucet Company